

**MITCHELTON
OSBORNE ROAD
QLD 4053**

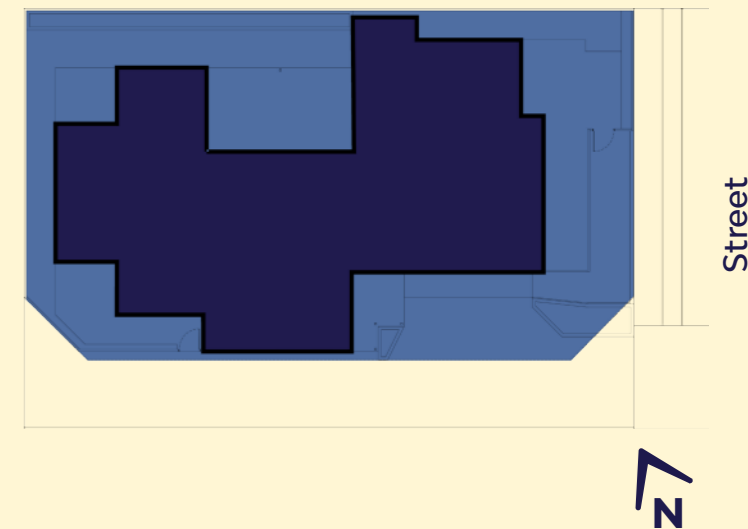

Bedroom 3

Bedroom / Ensuite	33 m ²
Common Internal Area	87 m ²
External Area	291 m ²
TOTAL AREA	411 m²



NOTE: DESIGNS SUBJECT TO CHANGE

OTHER PARTICIPANT'S PRIVATE SPACE



**IMPROVED
LIVEABILITY**



**FULLY
ACCESSIBLE**



**HIGH PHYSICAL
SUPPORT**

enliven HOUSING

**Enquiries 1300 ENLIVEN
enlivenhousing.com.au**